



TK International  
020 7794 8700  
www.t-k.co.uk

Residential Sales  
Residential Lettings  
Property Management

Sales Office:  
9 Heath Street  
Hampstead  
London NW3 6TP  
E: sales@t-k.co.uk

Lettings Office:  
16-18 Heath Street  
Hampstead  
London NW3 6TE  
E: lettings@t-k.co.uk

Instagram: tk.international  
Twitter: @tk\_int  
LinkedIn: TK International  
Facebook: TK International



## **Visage Apartments Winchester Road Swiss Cottage NW3**

An exceptionally bright and spacious two bedroom, two bathroom lateral apartment on the 5th floor of an exclusive modern apartment block, which is served by passenger lifts and a 24 hour concierge desk, with the added benefit of a secure underground parking space.

Benefits include a Juliette balcony from the reception room and wonderful far reaching views, only available to apartments situated on the higher floors of this wonderful development.

Visage Apartments is a prestigious modern development in Swiss Cottage, just moments from the underground station (Jubilee Line) in addition to a large gymnasium with swimming pool, GP surgery and pharmacy, and also conveniently located for access to the vast spaces of Primrose Hill and Regents Park.

**£895,000**

**SOLE AGENT**

**Leasehold**









# Winchester Road, Swiss Cottage, NW3

Approximate Area = 989 sq ft / 91.8 sq m

For identification only - Not to scale

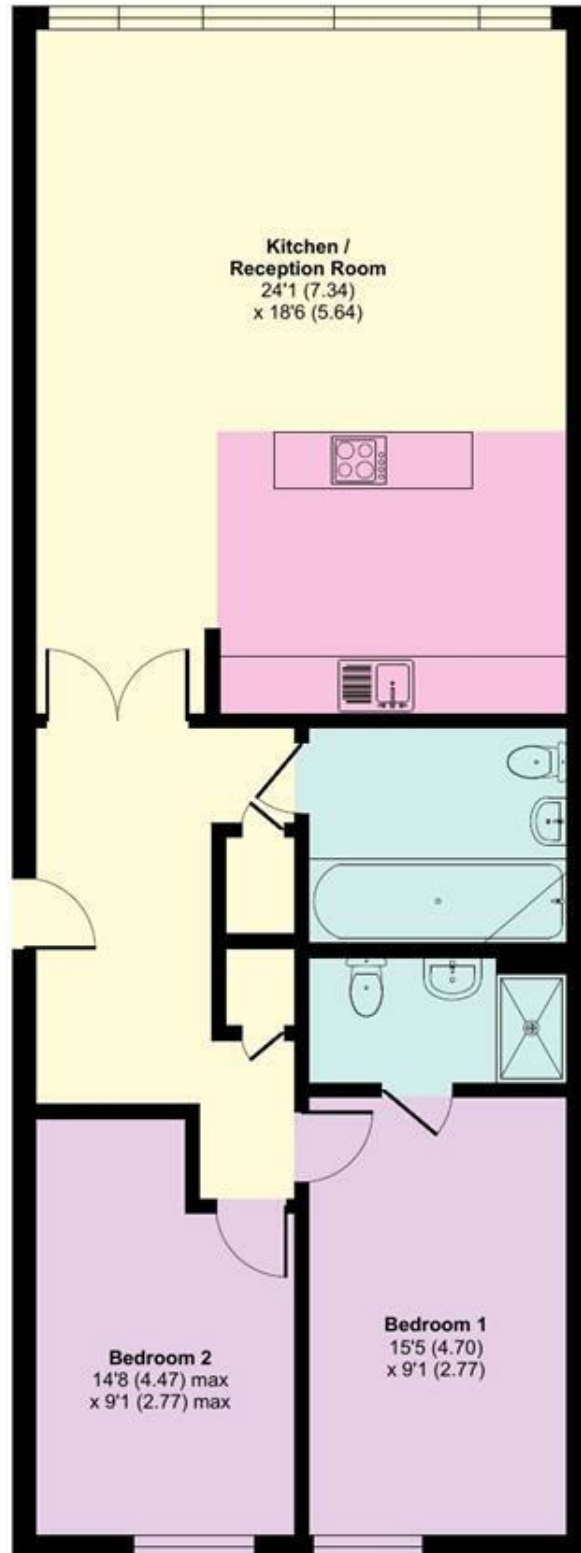

FIFTH FLOOR



Floor plan produced in accordance with RICS Property Measurement Standards incorporating International Property Measurement Standards (IPMS2 Residential). © nichecom 2022. Produced for TK (Hampstead) Ltd. REF: 886792